

### ■ About the company

B-Pro Safeguard, Inc. was created to serve the requirements of the Department Of Defense UFC 4-010-01 and the GSA and to provide the U.S. government the most advanced and cost effective protective glazing systems. The B-Pro products were developed by the world's most experienced engineers in the field and were subjected to a rigorous series of blast and AAMA weather testing.

### ■ Products & Aesthetics

The real-life experience of the B-Pro engineering team which include hundreds of thousands successful installations as well as the developing of numerous blast mitigation windows, doors and curtainwall systems, has provided B-Pro with the expertise in designing and refining the product in order to meet the most demanding architectural criteria while providing the highest level of blast protection required.

### ■ Technical Support and Fabrication

B-Pro Safeguard erected a state of the art plant quipped with modern machinery dedicated for the manufacturing of blast mitigation window systems. The B-Pro team is committed to quality, service and support.

The B-Pro 900 is a low maintenance, efficient, low cost window with out standing ease of installation at any given condition. Its versatile design allows for any archtechural implementation. This is a thermally broken profiles equipped with insulated Glass Unit to comply with any project specification.



ATI Dynamic Pressure Water Test

### ■ System performance

Air infiltration : 6.24 psf /ASTM E283-04

Static Pressure Water Resistance : 15 psf /ASTM E331

Dynamic Pressure Water Resistance : 15 psf /ASTM 501.1

Structural Performance : +/- 45 psf /ASTM E330-02

### ■ Blast Rating

B-Pro Blast Levels	A*	B	C	Blast performance demonstration
Impulse (psi*msec)	43			Blast performance is demonstrated through project specific analysis.
Pressure ( psi )	7			
B-Pro 900	V			

\*Level A corresponds to the UFC 4-010-01 DoD Min. requirements . where "conventional construction standoff distances are achieved".

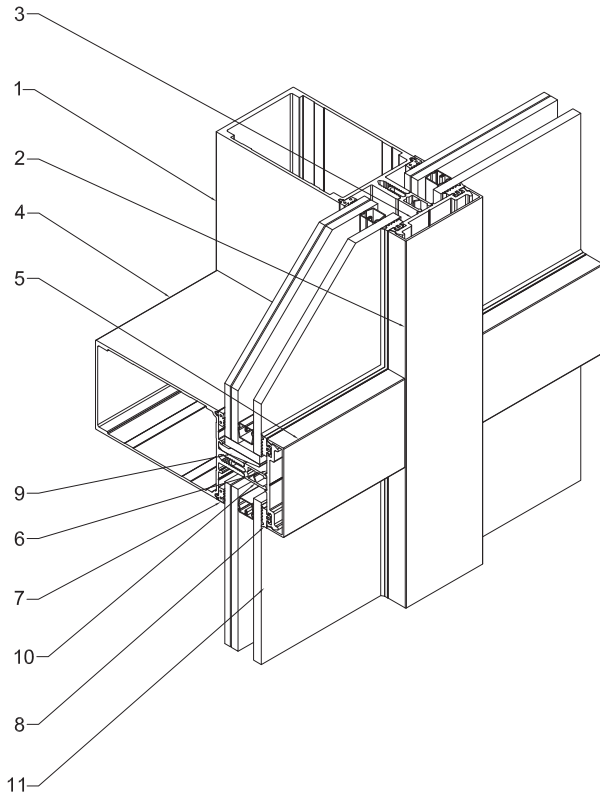

- 1 - Vertical Mullion
- 2 - Vertical Cap
- 3 - Vertical Pressure Plate
- 4 - Horizontal Mullion
- 5 - Horizontal Cap
- 6 - Horizontal Pressure Plate
- 7 - Internal Glazing Gasket
- 8 - External Glazing Gasket
- 9 - Glass Support
- 10 - Thermal Polyamid
- 11 - Insulating Glass Unit

### Vertical Mullion

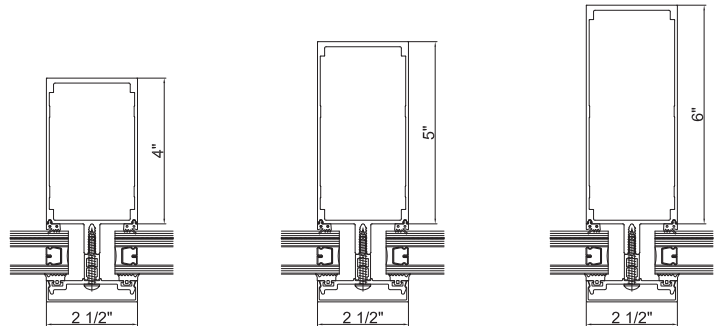

### Horizontal Open Mullion

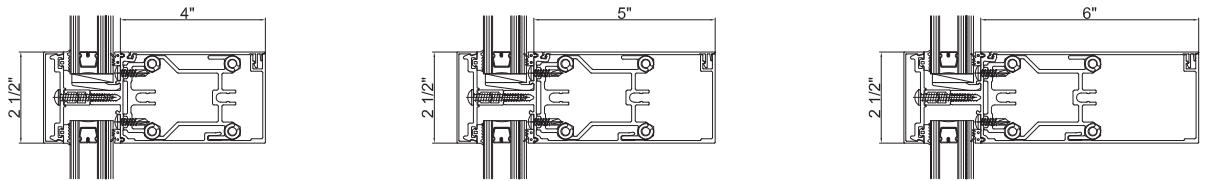

### Horizontal Turbular Mullion

